

WELDED CYLINDERS

3000 PSI - SINGLE ACTING - DRILLED ROD END AND BASE MOUNT

Replacement cylinders that fit Meyer, Western Diamond, Arctic, and Fish snow plows

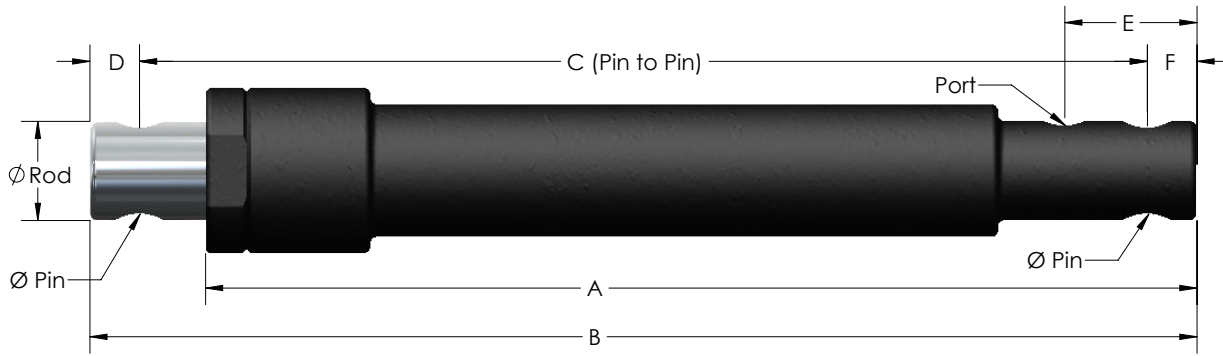

MODEL	Rod Dia. (in)	Stroke (in)	A (in)	B (in)	C (in)	D / F (in)	E (in)	Bore (in)	Pin Dia (in)	Weight (lbs.)
PX-M-SP-1506-0625	1.5	6	11.88	13.38	12.00	0.69	2.00	1.75	0.62	10
PX-M-SP-1510-0625		10	15.88	17.63	16.25					13
PX-M-SP-1512-0625		12	17.88	13.38	18.00					14
PX-M-SP-2012-0625	2.0		17.25	19.50		0.75	2.19	2.25		22
PX-W-SP-1506-0750	1.5	6	12.63	14.38	13.00	0.69	2.75	1.75	0.75	10
PX-W-SP-1508-0750		8	14.63	16.63	15.25					12
PX-W-SP-1510-0750		10	16.63	18.63	17.25					14
PX-W-SP-1510-1000										1.00
PX-W-SP-2006-0750	2.0	6	12.63	14.69	13.19	0.75		2.25	0.75	17
PX-W-SP-2010-1000		10	16.63	18.63	17.25	0.69		2.25	1.00	23
PX-W-SP-2016-1000		16	22.63	25"	23.63			2.25	1.00	29
PX-A-SP-1510-0750	1.5	10	16.63	18.50	17.00	0.75	2.75	1.75	0.75	12
PX-A-SP-1512-0750		12	18.63	20.50	19.00					14
PX-F-SP-1510-1000	1.5	10	16.38	18.75	17.25	0.75	2.69	1.75	1.00	14
PX-F-SP-1512-1000		12	18.44	20.88	19.38		2.63			14
PX-F-SP-2010-1000	2.0	10	16.13	18.75	17.25		1.72	2.25	1.25	21
PX-F-SP-2016-1250		16	22.50	25"	23.25	0.88	2.75			28

All ports are 1/4" NPT

DESCRIPTION

- Designed to fit Meyer, Western, Arctic and Fish plow applications.
- Exterior finish powder painted black.
- Standard NPT ports.
- 100% pressure test to 1.3 times rated pressure.
- Chrome plated rod.

