

4

3

2

1

B

B

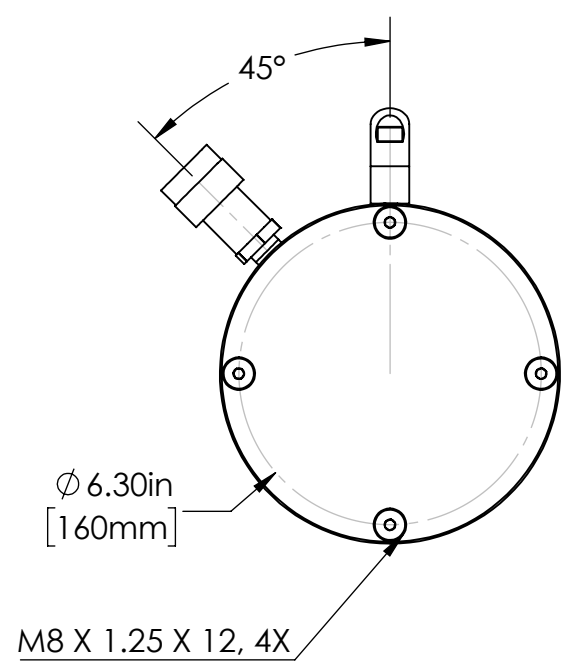
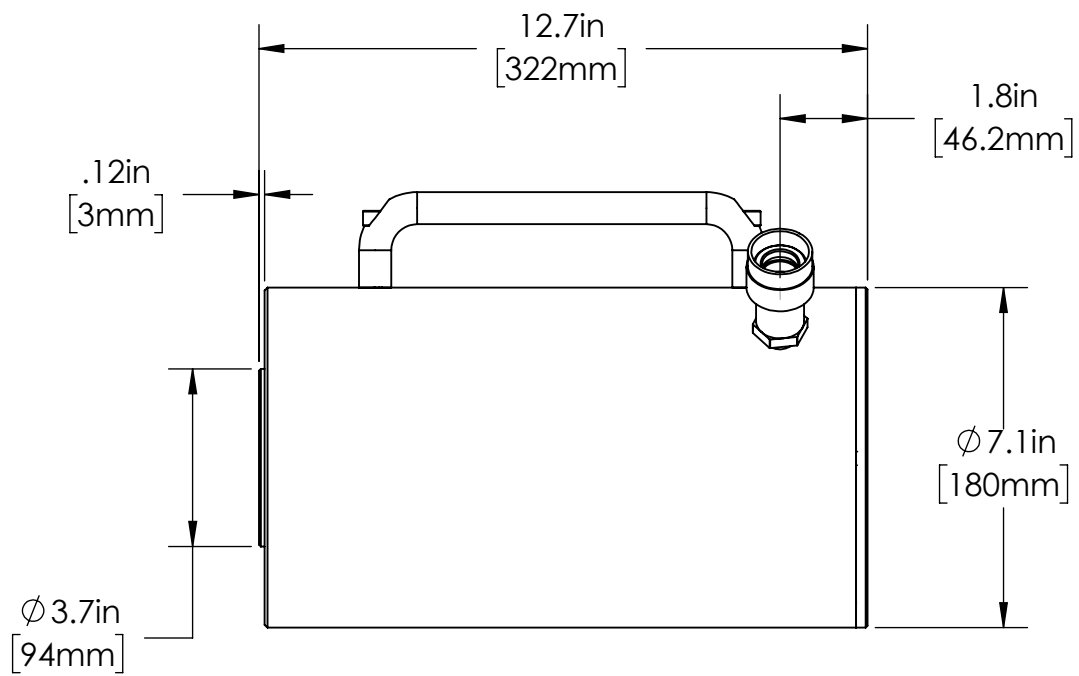
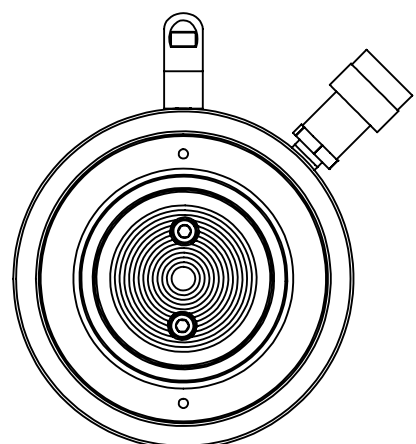

NOTES:

1. DO NOT SCALE DRAWING.
2. ROD DIAMETER: 4.33" (110mm)
3. BORE DIAMETER: 5.31" (135mm)
4. STROKE: 6.0" (152.3mm)
5. BORE EFFECTIVE AREA: 22.19 SQ.IN. (143.1 SQ. cm)
6. BORE OIL VOLUME: 133 CU.IN. (2.2L)
7. EXTEND FORCE: 100 TONS
8. REMOVABLE SADDLE.
9. APPROXIMATE WEIGHT: 48.3 LBS (21.9 KG)
10. STEEL BASE PLATE FOR INCREASED DURABILITY

A

A

UNLESS OTHERWISE SPECIFIED: DIMENSIONS ARE IN INCHES.		NAME	DATE
TOLERANCES: FRACTIONAL ±1/16 ANGLES ±1° ONE PLACES ±.050 (1.25mm) TWO PLACES ±.010 (.25mm) THREE PLACES ±.005 (.13mm) FINISH 125 MAX C/B .020		JJJ	12/26/18
THIRD ANGLE PROJECTION		CHECKED	
PROPRIETARY AND CONFIDENTIAL		ENG APPR.	JJJ 12/26/18
THE INFORMATION CONTAINED IN THIS DRAWING IS THE SOLE PROPERTY OF PowerX International. ANY REPRODUCTION IN PART OR AS A WHOLE WITHOUT THE WRITTEN PERMISSION OF PowerX International IS PROHIBITED.		MFG APPR.	
MATERIAL		Q.A.	
FINISH		COMMENTS:	
DO NOT SCALE DRAWING			



TITLE: CYLINDER, ALUMINUM BODY, INSTALLATION DRAWING		
SIZE	DWG. NO.	REV
B	CAL100-6	A
SCALE: 1:4	WEIGHT:	SHEET 1 OF 1

A	C18-12-151	12/26/2018	JJJ	RELEASE OF DRAWING	JJJ	12/26/18
REV.	ECN.	DATE	DRAWNBY	DESCRIPTION	APPROVED	APPR. DATE
REVISIONS						

4

3

2

1