

4

3

2

1

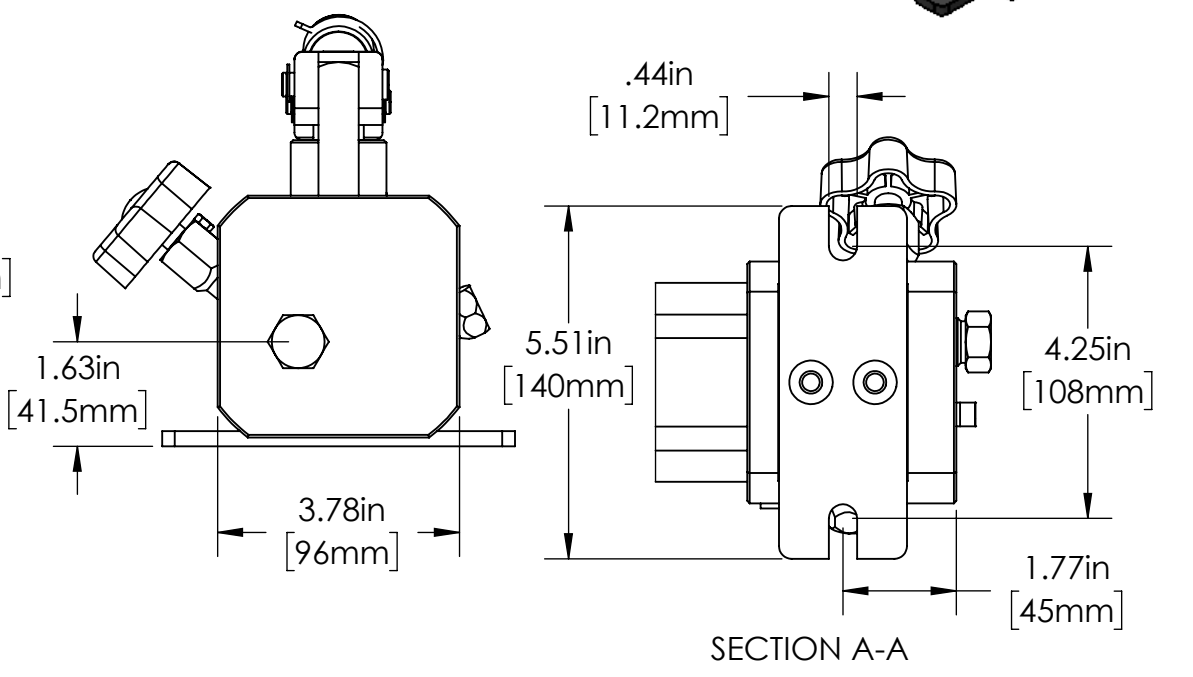
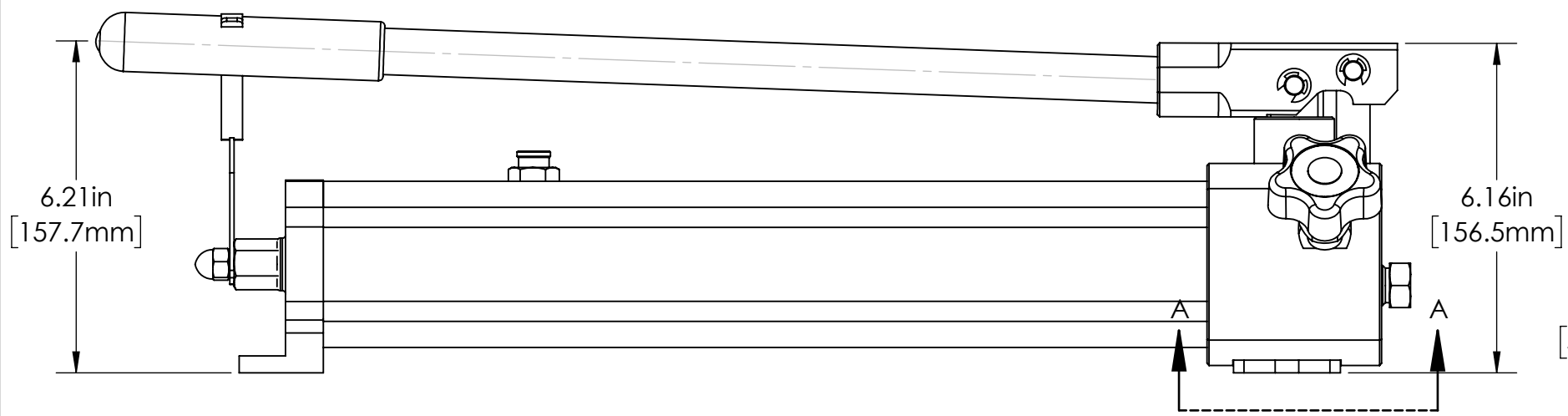
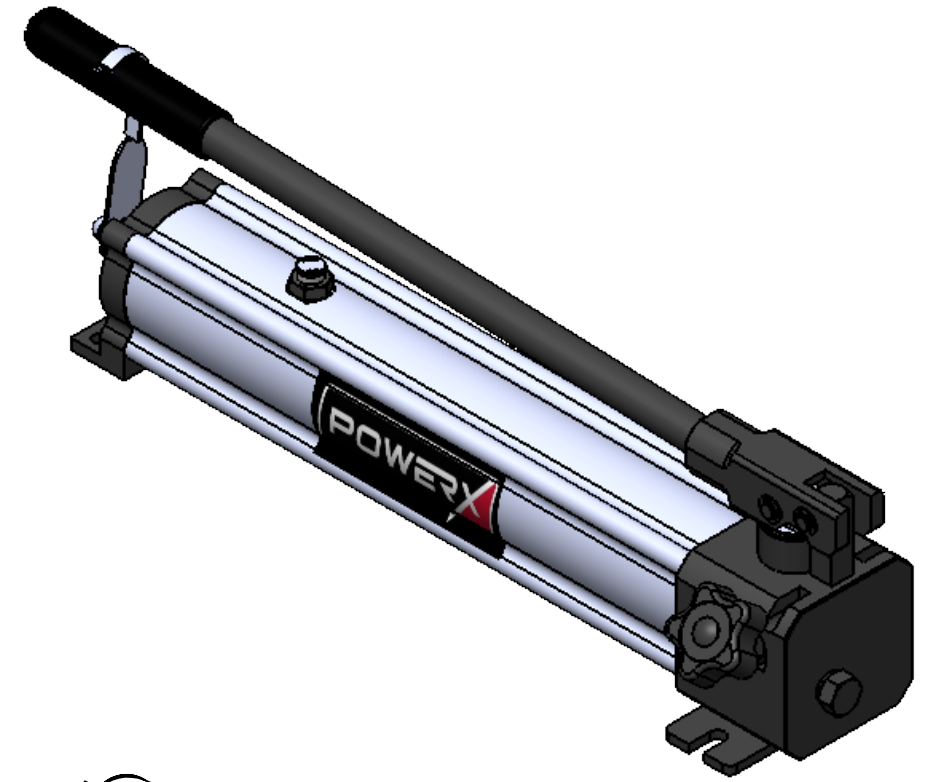
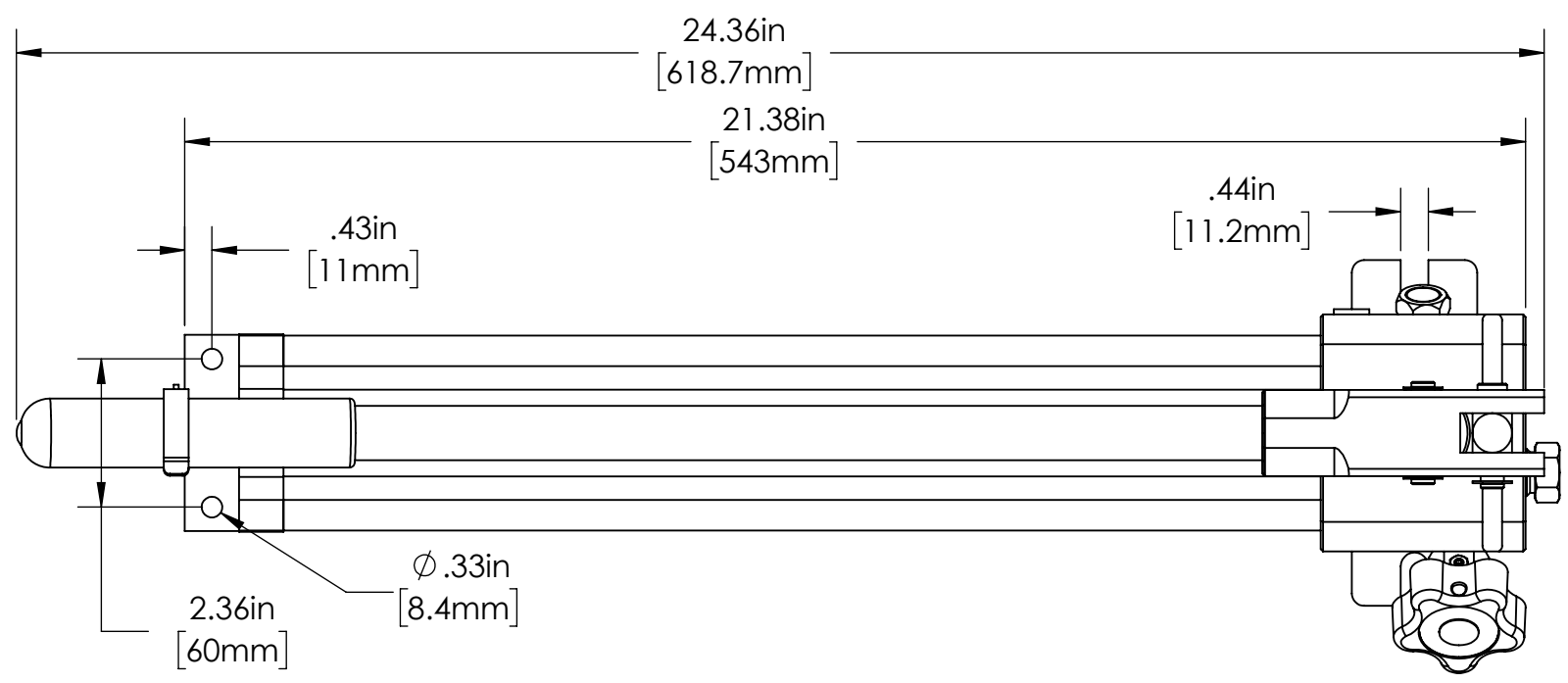

ITEM NO.	OIL CAPACITY (in3)	SPEED	PRESSURE RATING (PSI)		OIL / STROKE (IN3)		HANDLE EFFORT (LBS)	PORT SIZE	WEIGHT (LBS)
			1ST STAGE	2ND STAGE	1ST STAGE	2ND STAGE			
P61L-40K	61	2	300	40,600	.79	.04	95	3/4-16UNF	16.3

A

A

REV.	ECN.	DATE	DRAWNBY	DESCRIPTION	APPROVED	APPR. DATE
D	C18-09-112	9/18/2018	JJJ	ADDED MISSING MOUNTING HOLES IN REAR MOUNT; CORRECT MAXIMUM PRESSURE TYPO IN CHART	JJJ	9/18/18
C	C18-09-110	9/17/2018	JJJ	UPDATED PRODUCT COLORS	JJJ	9/17/18
B	C18-06-062	6/6/2018	JJJ	UPDATED FILE NAMES	JJJ	6/6/18
A	C18-05-59	5/31/18	JJJ	RELEASE OF DRAWING	JJJ	6/4/18

THIRD ANGLE PROJECTION

**PROPRIETARY AND CONFIDENTIAL**

THE INFORMATION CONTAINED IN THIS DRAWING IS THE SOLE PROPERTY OF PowerX International. ANY REPRODUCTION IN PART OR AS A WHOLE WITHOUT THE WRITTEN PERMISSION OF PowerX International IS PROHIBITED.

UNLESS OTHERWISE SPECIFIED: DIMENSIONS ARE IN INCHES.		NAME	DATE
TOLERANCES: FRACTIONAL ±1/16 ANGLES ±1° ONE PLACES ±.050 (1.25mm) TWO PLACES ±.010 (.25mm) THREE PLACES ±.005 (.13mm) FINISH 125 MAX C/B .020	DRAWN	JJJ	5/30/18
MATERIAL  FINISH  DO NOT SCALE DRAWING	CHECKED		
	ENG APPR.	JJJ	6/4/18
	MFG APPR.		
	Q.A.		
COMMENTS:			



TITLE:  
**PUMP, HAND, 61 CU.IN., STEEL HEAD, 40K**

SIZE DWG. NO. REV  
**B** P61L-40K - Install **D**

SCALE: 1:3 WEIGHT: SHEET 1 OF 1

4

3

2

1