

4

3

2

1

B

B

A

A

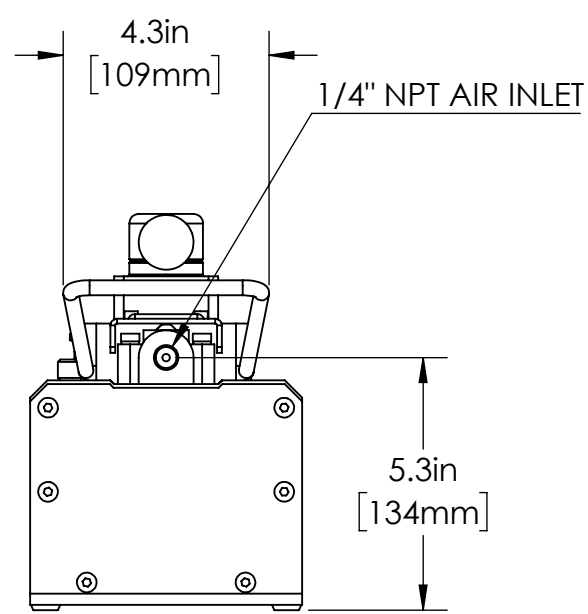
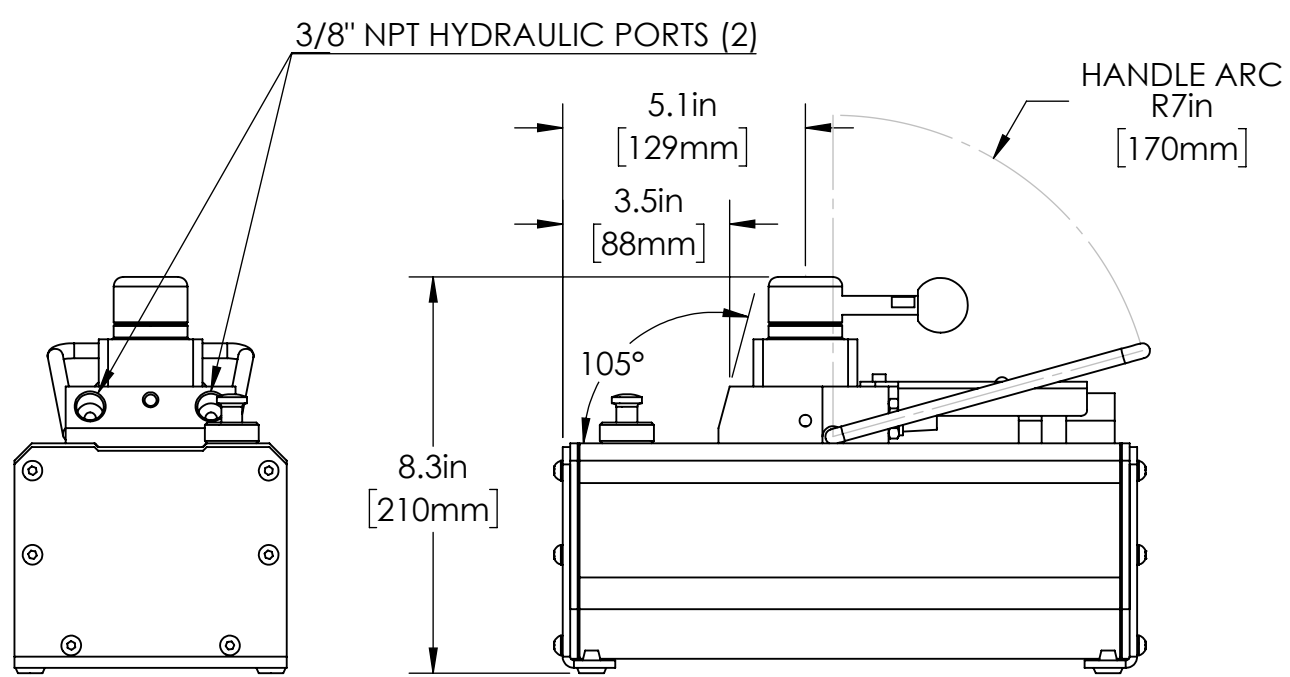
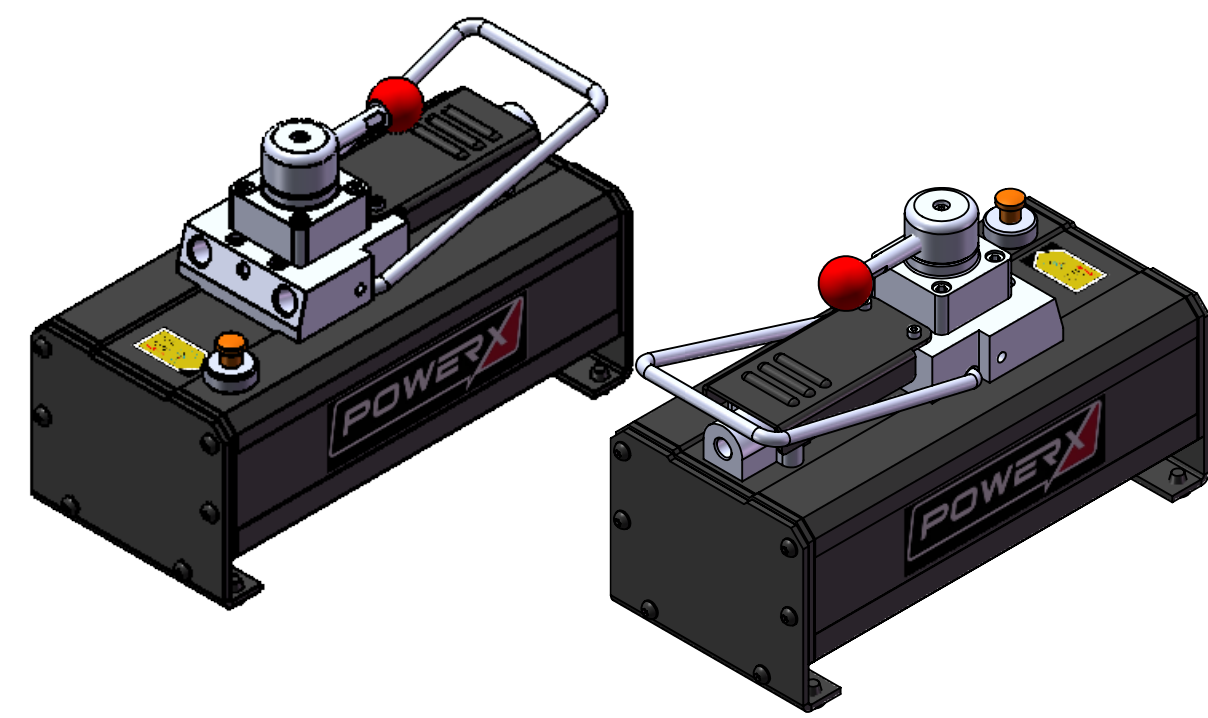
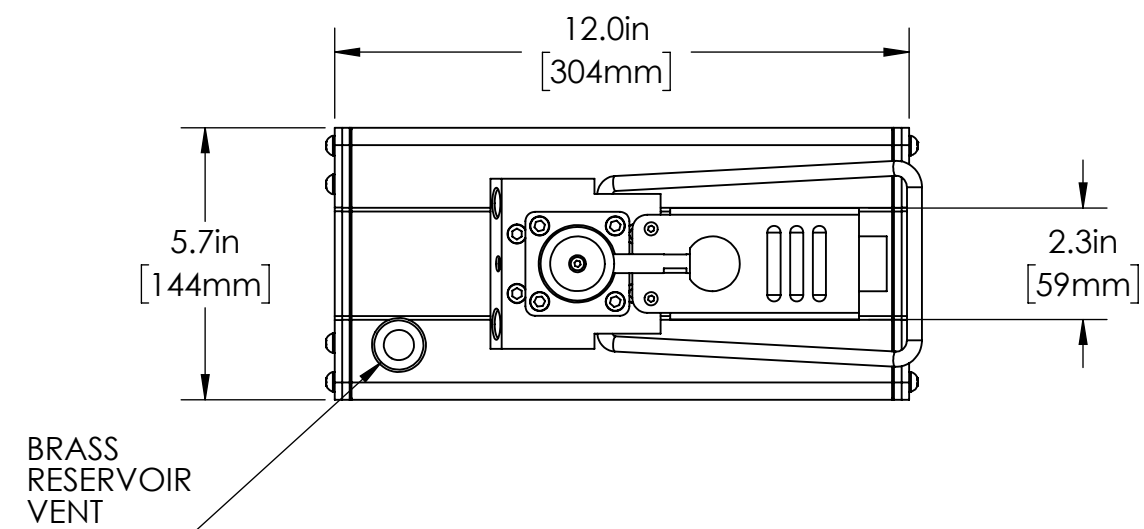

- NOTES:**
1. MAXIMUM PRESSURE RATING 10,000 PSI OTHER PRESSURES AVAILABLE UPON REQUEST.
  2. INLET AIR PRESSURE: 40 TO 170 PSI.
  3. AIR EXHAUST MUFFLE INCLUDED.
  4. RESERVOIR OIL CAPACITY, APPROX. 160 CU.IN.
  5. USUABLE OIL VOLUME APPROX. 122 CU.IN.
  6. OIL FLOW:
    1. NO LOAD: 82 CU.IN./MIN
    2. 10,000 PSI: 13 CU.IN./MIN
  7. RESERVOIR, EXTRUDED ALUMINUM ALLOY.
  8. RESERVOIR, TREDDLE, AND END CAPS ARE PAINTED OR ANODIZED BLACK.
  9. WEIGHT: APPROX. 22 LBS, INCLUDING OIL.

UNLESS OTHERWISE SPECIFIED: DIMENSIONS ARE IN INCHES.		NAME	DATE
TOLERANCES: FRACTIONAL ±1/16 ANGLES ±1° ONE PLACES ±.050 (1.25mm) TWO PLACES ±.010 (.25mm) THREE PLACES ±.005 (.13mm) FINISH 125 MAX C/B .020		JJJ	04/03/18
THIRD ANGLE PROJECTION		JJJ	04/17/18
PROPRIETARY AND CONFIDENTIAL			
THE INFORMATION CONTAINED IN THIS DRAWING IS THE SOLE PROPERTY OF PowerX International. ANY REPRODUCTION IN PART OR AS A WHOLE WITHOUT THE WRITTEN PERMISSION OF PowerX International IS PROHIBITED.			
MATERIAL		COMMENTS:	
FINISH			
DO NOT SCALE DRAWING			

**POWERX**

TITLE:  
**INSTALLATION DRAWING  
PA6-122D**

SIZE	DWG. NO.	REV
<b>B</b>	<b>PA6-122D-Install</b>	<b>A</b>
SCALE: 1:4	WEIGHT:	SHEET 1 OF 1

A	C18-11-134	4/17/18	JJJ	RELEASE OF DRAWING	JJJ	11/12/18
REV.	ECN.	DATE	DRAWNBY	DESCRIPTION	APPROVED	APPR. DATE
REVISIONS						

4

3

2

1