

4

3

2

1

3/8" NPT HYDRAULIC PORT

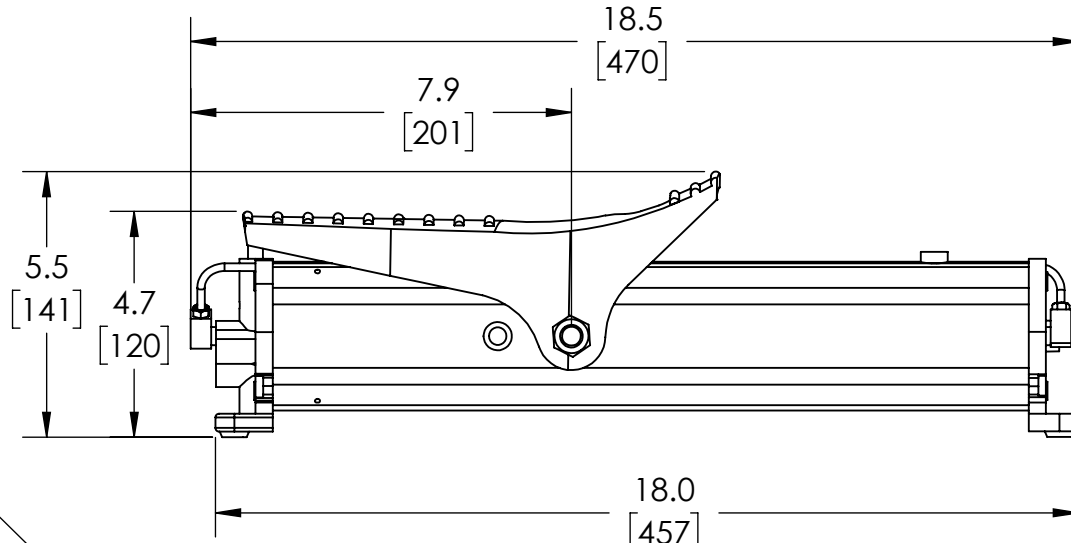
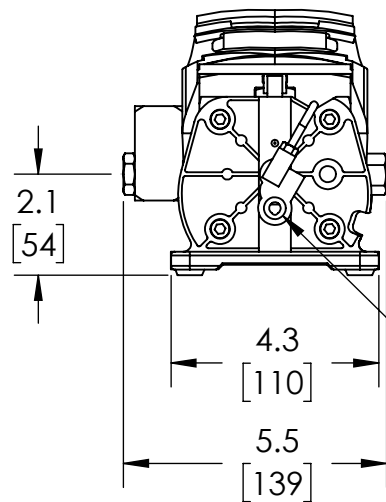

1/4" NPT AIR INLET PORT

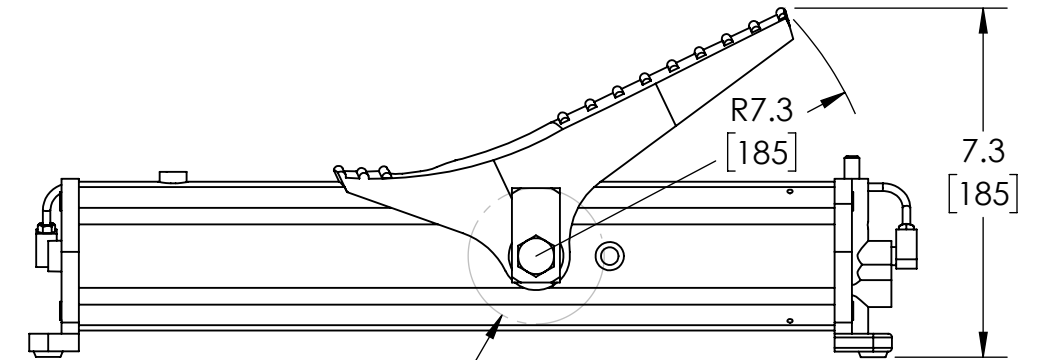
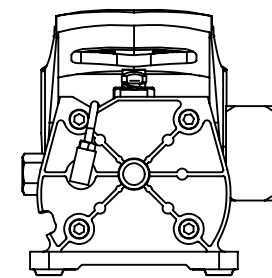
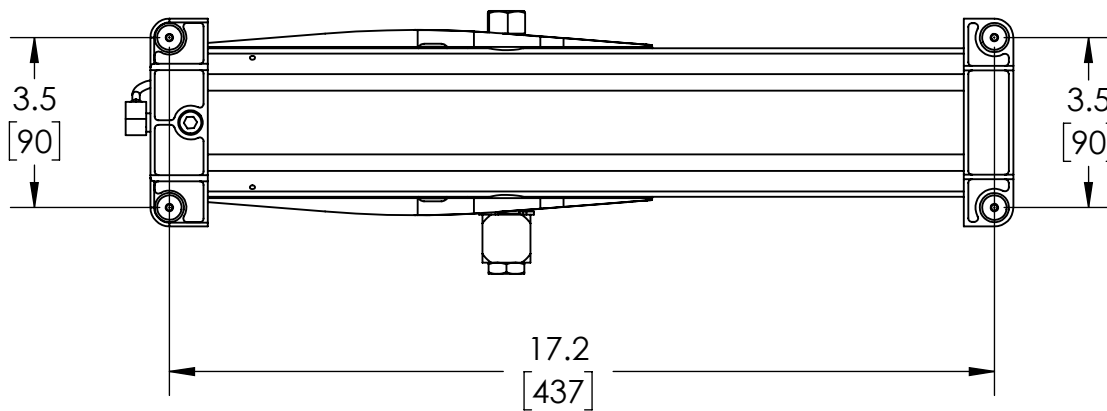

Ø2.8 [72] HYDRAULIC SWIVEL Ø

NOTES:

1. MAXIMUM PRESSURE RATING 10,000 PSI, OTHER PRESSURES AVAILABLE UPON REQUEST.
2. INLET AIR PRESSURE: 40 TO 170 PSI.
3. RESERVOIR OIL CAPACITY, APPROX. 43 CU.IN.
4. USUABLE OIL VOLUME 37 CU.IN.
5. OIL FLOW:
 1. NO LOAD: 132 CU.IN./MIN
 2. 10,000 PSI: 16 CU.IN./MIN
6. RESERVOIR, EXTRUDED ALUMINUM ALLOY.
7. WEIGHT: APPROX. 12 LBS, INCLUDING OIL.

UNLESS OTHERWISE SPECIFIED: DIMENSIONS ARE IN INCHES.

TOLERANCES:
 FRACTIONAL ±1/16
 ANGLES ±1°
 ONE PLACES ±.050 (1.25mm)
 TWO PLACES ±.010 (.25mm)
 THREE PLACES ±.005 (.13mm)
 FINISH 125 MAX
 C/B .020

THIRD ANGLE PROJECTION

PROPRIETARY AND CONFIDENTIAL
 THE INFORMATION CONTAINED IN THIS DRAWING IS THE SOLE PROPERTY OF PowerX International. ANY REPRODUCTION IN PART OR AS A WHOLE WITHOUT THE WRITTEN PERMISSION OF PowerX International IS PROHIBITED.

MATERIAL

FINISH

DO NOT SCALE DRAWING

	NAME	DATE
DRAWN	JJJ	4/9/18
CHECKED		
ENG APPR.	JJJ	4/10/18
MFG APPR.		
Q.A.		
COMMENTS:		



TITLE:
PA9-37 INSTALLATION DRAWING

SIZE	DWG. NO.	REV
B	PA9-Install	A
SCALE: 1:4	WEIGHT:	SHEET 1 OF 1

REV.	ECN.	DATE	DRAWNBY	DESCRIPTION	APPROVED	APPR. DATE
A	C18-04-037	4/10/2018	JJJ	RELEASED	JJJ	4/10/18
REVISIONS						

4

3

2

1

B

B

A

A